

WHEREAS, the Pennsylvania Department of Transportation is requesting the acreage for vehicular improvements associated with the development of lands adjacent to the Nor-Bath Trail at the intersection of Airport Road (SR 987); and

WHEREAS, the County negotiated additional pedestrian and bicycle safety improvements within the right-of-way to be paid, installed and maintained by the developer.

NOW, THEREFORE, BE IT HEREBY ORDAINED AND ENACTED by the Northampton County Council, that it does hereby authorize the County Executive to sign on the requested documents as part of the Compliance & Stewardship Report, requested by the National Park Service for full conveyance of .0985 acres for the return of .0986 acres of land, in part by federal funds through LWCFE.

This ordinance was advertised on the ___ day of _____ 2022, and was adopted by the Northampton County Council on the ___ day of _____ 2022.

ATTEST:

Linda M. Zembo
Clerk to Council

Lori Vargo Heffner
County Council President

Lamont G. McClure
County Executive

Exhibit A



PA SPC/SOUTH ZONE
NAD 83 (2011)
EPOCH 2010.00

N/F
LHV NOR BATH LOT 1 LLC
DBV. 2018-1, PG.246370
PARCEL ID. L5-7-2-0508

N/F
NORTHAMPTON COUNTY
DBV. 622, PG.1030
PARCEL ID.
L5-11-1-PKB-0508C

N/F
SUNNY SLOPE FARMS INC.
DBV. F78, PG. 590
PARCEL ID. L5-6-10-0508

WESTERN LANDS
NOR-BATH TRAIL
RIGHT-OF-WAY TO
BE ACQUIRED
AREA=2,179
S.F./0.0500 ACRES

N/F
NORTHAMPTON COUNTY
DBV. 622, PG.1030
PARCEL ID.
L5-11-1-PKB-0508C

EASTERN LANDS
NOR-BATH TRAIL
RIGHT-OF-WAY TO
BE ACQUIRED
AREA=2,115
S.F./0.0485 ACRES

N/F
POWERCO SALES LLC
DBV. 2018-1, PG. 264481
PARCEL ID. L5-8-5-0508
7250 AIRPORT ROAD

N/F
NICHOLAS M. & LAMBROS ZUMAS
DBV. 2009-1, PG. 081310
PARCEL ID. L5-12-3A-1-0508
7259 AIRPORT ROAD

P.O.B.

P.O.B.

AIRPORT ROAD (SR 987)

EXISTING
RIGHT-OF-WAY
AS DEFINED
BY PENNDOT

GRAVEL TRAIL
GATE

PLAN DATE 02/14/22	PROJECT NATIONAL PARK SERVICE REPLACEMENT LAND	DEED REF. D.B.V. 622 , PG. 1030
REVISIONS	LHV NOR BATH LOT 1 LLC	PARCEL ID. L5-11-1 PKB-0508C
MUNICIPALITY COUNTY STATE	EAST ALLEN TOWNSHIP NORTHAMPTON COUNTY PENNSYLVANIA	of 1 JOB NO. 4396



Arthur A. Swallow Associates, LLC
1003-1005 North 19th Street
Allentown, PA 18104
610-820-6470 · Fax:610-820-5947

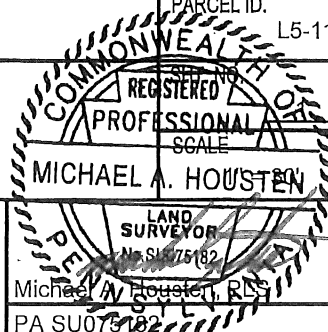

2/14/2022
Date

PA SU075182

Exhibit B

RIGHT-OF-WAY TO BE ACQUIRED FOR PENNDOT "WESTERN LANDS"

Northampton County

East Allen Township, Northampton County, Pennsylvania

February 14, 2022

ALL THAT CERTAIN piece, parcel or tract of land situate in East Allen Township, County of Northampton, Commonwealth of Pennsylvania, being situate along the westerly legal right-of-way line of Airport Road (S.R. 987), and the northerly right-of-way of the county trail, hereby offered for dedication being shown on an exhibit titled "National Park Service Replacement Land", prepared by Arthur A. Swallow Associates, LLC, dated February 14, 2022, being bounded and described further as follows, to wit:

BEGINNING at a point located at the intersection of the westerly legal right-of-way line for Airport Road (S.R.987) and the northerly right-of-way of the county trail;

Thence along westerly legal right-of-way line for Airport Road (S.R.987), South 07°51'31" East, 86.93 feet to a point;

thence along other lands previously offered for legal right-of-way, South 59°06'05" West, 28.04 feet to a point;

thence in and through lands now or formerly of Northampton County, North 06°54'09" West, 87.57 feet to a point;

thence along the lands now or formerly of Sunny Slope Farms Inc., North 59°06'05" East, 26.45 feet to a point, the **PLACE OF BEGINNING**.

CONTAINING: 2,179 Square Feet or 0.0500 Acres

Prepared by:
Michael A. Housten, PLS
Arthur A. Swallow Associates, LLC

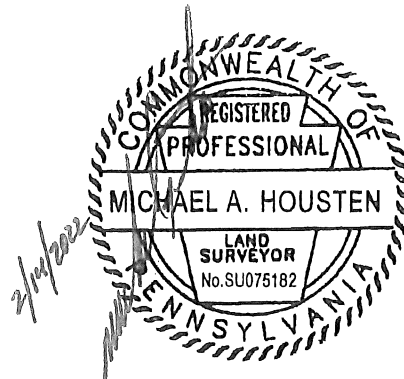

Exhibit C

RIGHT-OF-WAY TO BE ACQUIRED FOR PENNDOT "EASTERN LANDS"

Northampton County

East Allen Township, Northampton County, Pennsylvania

February 14, 2022

ALL THAT CERTAIN piece, parcel or tract of land situate in East Allen Township, County of Northampton, Commonwealth of Pennsylvania, being situate along the easterly legal right-of-way line of Airport Road (S.R. 987), and the northerly right-of-way of the county trail, hereby offered for dedication being shown on an exhibit titled "National Park Service Replacement Land", prepared by Arthur A. Swallow Associates, LLC, dated February 14, 2022, being bounded and described further as follows, to wit:

BEGINNING at a point located at the intersection of the easterly legal right-of-way line for Airport Road (S.R.987) and the northerly right-of-way of the county trail;

Thence along the lands now or formerly of LHV Nor Bath Lot 1 LLC, North 59°06'05" East, 27.14 feet to a point;

thence in and through lands now or formerly of Northampton County, South 07°01'02" East, 87.49 feet to a point;

thence along the lands now or formerly of Powerco Sales LLC, South 59°06'05" West, 25.74 feet to a point;

thence along the easterly legal right-of-way line for Airport Road, North 07°51'31" West, 86.93 feet to a point, the **PLACE OF BEGINNING**.

CONTAINING: 2,115 Square Feet or 0.0485 Acres

Prepared by:
Michael A. Houston, PLS
Arthur A. Swallow Associates, LLC

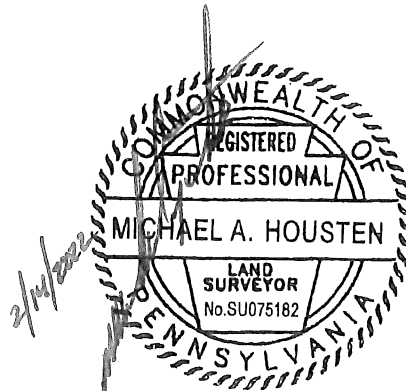

Exhibit E

LANDS TO BE TRANSFERRED TO NATIONAL PARK SERVICE

East Allen Township, Northampton County, Pennsylvania
June 2, 2022

ALL THAT CERTAIN piece, parcel or tract of land situate in East Allen Township, County of Northampton, Commonwealth of Pennsylvania, being situate along the easterly right-of-way of Airport Road (S.R. 987), and the northerly right-of-way of the county trail, hereby offered for dedication being shown on an exhibit titled "National Park Service Replacement Land", prepared by Arthur A. Swallow Associates, LLC, dated June 2, 2022, being bounded and described further as follows, to wit:

BEGINNING at a point located at the intersection of the easterly right-of-way line for Airport Road (S.R.987) and the northerly right-of-way of the county trail;

Thence along and in the lands now or formerly of LVH Nor Bath Lot 1 LLC the following two (2) courses and distances:

1. North 59°06'05" East, 347.85 feet to a point;
2. South 31°07'57" East, 12.25 feet to a point;

thence along the lands now or formerly of Northampton County, South 59°06'05" West, 353.24 feet to a point;

thence along easterly right-of-way line for Airport Road (S.R.987), North 07°20'07" West, 13.36 feet to a point, the **PLACE OF BEGINNING**.

CONTAINING: 4,294 Square Feet or 0.0986 Acres

Prepared by:
Michael A. Houston, PLS
Arthur A. Swallow Associates, LLC

